

01 STREET SCENE FROM CAMPFIELD ROAD  
1:250

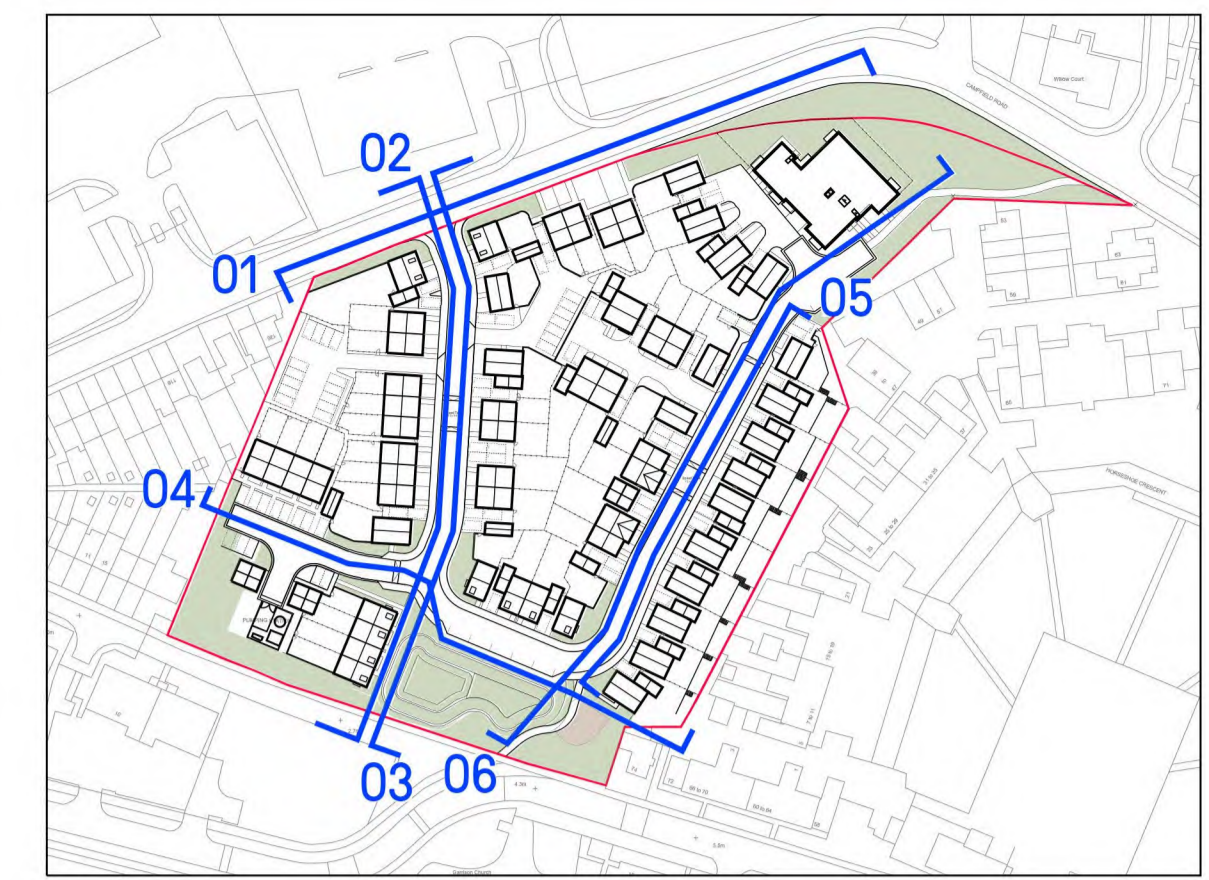

SITE KEY  
1:2000

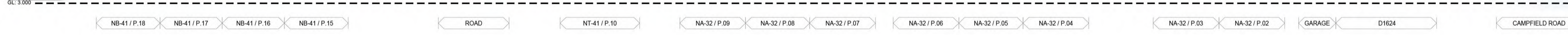

02 STREET SCENE WITHIN DEVELOPMENT  
1:250

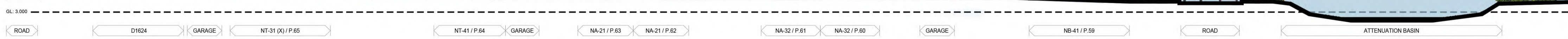

03 STREET SCENE WITHIN DEVELOPMENT  
1:250

<b>Notes</b> - Copyright in this drawing remains the property of BMS Architecture Limited. - Contractors and consultants are to advise BMS Architecture Limited of any discrepancies.	<b>Revision</b> A - Street scenes no. (4) & (5) moved on newly created sheet no. D-311 and renamed (5) & (6). New street scene added (3). B - Street scenes 1: Block A railings omitted, brick boundary to follow detailed brick wall. Street scenes 2 and 3 updated to correspond to boundary treatments plan (D-107_Rev G) C - Street Scene 1: Apartment Block A height amended to correspond to latest elevations (D-222_Revision G).	<b>Date</b> 07.11.22 23.03.23 01.06.23	<b>By</b> RR MT MT	<b>Chkd</b> JB JB JB	<b>CDM Notes</b> 	<b>Project</b> CAMPFIELD ROAD SHOEBOURNESS SOUTHEND-ON-SEA	<b>Drawing</b> PROPOSED SITE LAYOUT STREET SCENES	<b>Client</b> 

